



中国国际供应链促进博览会

China International Supply Chain Expo (CISCE)

MEDIA GUIDE







中国国际供应链促进博览会

China International Supply Chain Expo (CISCE)

MEDIA GUIDE

THE FOURTH CHINA INTERNATIONAL
SUPPLY CHAIN EXPO (CISCE)

June 2026



中国国际供应链促进博览会

China International Supply Chain Expo (CISCE)

Location

Venue:

China International Exhibition Center (Shunyi Venue)

Contact Information of the Media Center

Tel: +86-10-80468977

Fax: +86-10-80468978

+86-10-80468979

Media Center Wireless Network

The Media Center provides wireless internet service, and accredited journalists can connect to the “Ciscemedia” network.

Online Media Center

The Fourth China International Supply Chain Expo (CISCE) has an online Media Center (website: <https://en.cisce.org.cn/news/news.html>), which consists of three sections: News, Latest Notice, and Photos & Videos. It is accessible on both mobile devices and computers, allowing users to conveniently stay updated with relevant information in real time.

Media Center in Apps

The Fourth CISCE has established a "CISCE Media Home" WeChat mini program. During the expo, relevant information can be conveniently accessed by using mobile devices to scan the QR codes of the official WeChat accounts of the China Council for the Promotion of International Trade (CCPIT) and the CISCE, or the QR code of the "CISCE Media Home". Registered journalists can also log in to the "CISCE Media Home" mini-program through their mobile phone numbers and verification codes to obtain images and videos. When using these materials, please indicate that the copyright is owned by the CCPIT, China International Exhibition Center Group Corporation, or the CISCE.



“中国国际供应链促进博览会”微信公众号



“中国贸促”
微信公众号



“链媒之家”
小程序



Welcoming Address

Dear journalists,

Welcome to the Fourth China International Supply Chain Expo (hereinafter referred to as "CISCE"). With the theme of "Connecting the World for a Shared Future", the Fourth CISCE will take place from June 22 to June 26 at the China International Exhibition Center(Shunyi Venue). As the first internationally renowned exhibition dedicated to the global supply chain, the CISCE serves as a gateway for China to establish a new development pattern and promote high-level openness. It provides a platform for companies worldwide to strengthen cooperation, share opportunities, facilitate industry coordination among countries in a more organized and efficient manner, and contribute to the establishment of resilient global industrial and supply chains.

To facilitate media coverage, we have established the Media Center at the Venue from June 22 to June 26. The Media Center comprises the Comprehensive Service Area, the Media Working Area, the Press Area, the Interview Area, and the Catering & Refreshment Area. Equipped with state-of-the-art office facilities and high-speed internet connectivity, the Media Center ensures that journalists receive professional, efficient, and convenient services.

The success of the Fourth CISCE would not have been possible without your support and dedication. We sincerely welcome all journalists to the CISCE and wish you every success in your work!

Media Center of the Fourth CISCE

June 2026



Media Guidelines

- Registered journalists are invited to cover the Fourth CISCE.
- Registered journalists are required to collect their media credentials at the designated location before the specified deadline.
- Registered journalists with valid credentials can access the Media Center. Access to specific designated interview areas is granted with specialized credentials or identification. Media credentials should not be transferred or lent to others.
- Registered journalists can stay updated on the expo's information, service details, and notices by logging into the online Media Center or the "CISCE Media Home" mini program, or through electronic screens within the Media Center.
- Registered journalists are provided with transportation services during the Fourth CISCE and can enjoy free bus rides with their media credentials.
- Registered journalists are required to adhere to the security regulations of the Fourth CISCE. Carrying flammable or explosive materials, controlled knives, or any hazardous items is strictly prohibited.



Table of Contents

I. Media Center

Basic Information	08
Introduction to Functional Areas	08
Reservation Services.....	12
Catering and Refreshment Services.....	13
Medical Services and Nursing Room.....	13
Media Center Map.....	14
Transportation Services.....	20
Hotel Services.....	22

II. Guide Maps of China International Exhibition Center (Shunyi Venue)

Venue Layout	28
Traffic Map.....	32



中国国际供应链促进博览会

China International Supply Chain Expo (CISCE)

**MEDIA
CENTER**

1. Basic Information

The Fourth CISCE will feature a Media Center as the main workspace for registered journalists, offering services such as conference interviews, forum information, transportation, and catering. It will be operational from June 22 to June 26.

2. Introduction to Functional Areas

Comprehensive Service Area

This area, located in front of Conference Room W201 on the second floor near the South Entrance of the venue, offers the following services:

(1) Consultation and volunteer services

- Shuttle bus schedules, dining times, and other relevant information are displayed on screens at the front desk.
- News broadcasts are provided on television screens in the lobby.
- Consultation services are available for interview room reservations and related inquiries.
- First aid kits are available for emergency situations.
- Additional consultation services are offered as needed.

(2) Internet services

(3) Printing area

(4) Official photos area

(5) Common storage



Media Working Area

The Media Working Area is located in the rear section of Conference Room W201 on the second floor and the outer corridor on the first floor of the South Entrance of the venue. This area is equipped with power supply interfaces, broadband network interfaces, and office equipment. It also includes newspaper racks and media terminal displays, primarily serving as a media office, a resting and waiting area for guests, and a space for conducting guest interviews.

First Floor of the South Entrance of the Venue:

W102: Media Center Workroom

W103: China Media Group (CMG) Workroom

W104: Guest Interview Room

Second Floor of the South Entrance of the venue

W202: People's Daily Workroom

Second floor of the W1 Venue

W1-203: Xinhua News Agency Workroom

Second Floor of the W2 Venue

W2-201: CMG Business Programming Center Workroom

W2-202: CCTV.com Workroom

W2-203: China Global Television Network (CGTN)
Workroom

Second Floor of the W3 Venue

W3-201: Beijing Shisoone Culture Media Co., Ltd.
Workroom

W3-202: China Media Group (CMG) Workroom

W3-203: CMG Digital News Center Workroom

Second Floor of the W4 Venue
W4-203: XINHUANET Workroom

Second Floor of the E1 Venue
E1-203: CCPIT Digital Media Center (China Trade News)
Workroom

Second Floor of the E2 Venue
E2-201: CCPIT Digital Media Center (China Trade News)
Workroom
E2-203: China.org.cn Workroom

Second Floor of the E3 Venue
E3-201: People's Pictorial Workroom
E3-202: Phoenix TV Workroom

Second Floor of the E4 Venue
E4-201: Beijing Radio & Television Station Workroom
E4-202: Huanqiu.com Workroom
E4-203: China Media Group Mobile Workroom



Press Conference Area

The Press Conference Area is situated in Conference Room W105 at the South Entrance of the Venue, with a capacity to accommodate 200 people. VIP area with VIP lounge. This area will serve as the location for press conferences during the expo. The main equipment and features include:

- A thematic backdrop.
- A podium.
- A basic lighting setup.
- A photography and videography platform.
- Simultaneous interpretation equipment.
- Several wireless microphones.
- Provide table sign and water services.

Interview Area

(1) An area for interviews is situated in the public area on the second floor of the South Entrance of the Venue.

(2) Each exhibition hall has its own public interview room.

Catering and Refreshment Area

The Catering Area is situated in the corridor outside Conference Room W202 on the second floor of the South Entrance of the venue, with a capacity to accommodate up to 120 people for dining.

The Refreshment Area is located near the escalator exit and in the corridor outside Conference Room W202 on the second floor of the South Entrance of the venue. It is furnished with sofas and provides coffee, beverages, tea, snacks, and more throughout operational hours, and supplement regularly.



Achievements Exhibition Area of CCPIT's Application-Oriented Think Tank Construction

This exhibition area, located on the second floor of the South Entrance, showcases the CCPIT's achievements in the construction of application-oriented think tanks. These achievements include the Global Economic and Trade Measures Index, the Report on the Business Environment of European Union, the Research Report on China's Foreign Investment Business Environment, China Trade Newspaper and China's Foreign Trade magazine, etc.

3. Reservation Services

The Media Center offers reservation services for public interview rooms and office facilities for media professionals. Media representatives can make on-site appointments at the information desk outside Conference Room W201 on the second floor of the South Entrance.

Registered journalists can also access the "CISCE Media Home" mini program and complete the corresponding media service application form (for interview requests). Once the staff confirms the application details, relevant service confirmation information will be provided to the media.



4. Catering and Refreshment Services

The Media Center provides complimentary lunch and dinner for registered journalists during specified opening hours. Refreshment services are available in the corridor outside Conference Room W202 on the second floor of the South Entrance.

Location of Media Dining Area: The corridor outside Conference Room W202 on the second floor of the South Entrance.

Dining Schedule:

June 22 to June 26

•Lunch: 11:00-14:30

•Dinner: 17:30-20:30

5. Medical Services and Nursing Room

Medical services are available in Conference Room W201, which is equipped with first aid kits and a medical room to provide emergency medical assistance.

6. Media Center Map

一楼区域 First Floor

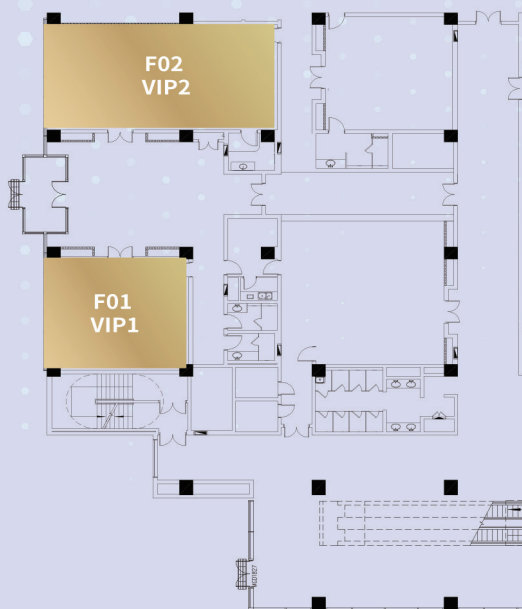

A 综合服务区 Media Service Area

- A01 预约台
Reservation Desk
- A02 咨询台
Information Desk
- A03 图片中心
Picture Center

B
B
B

Area

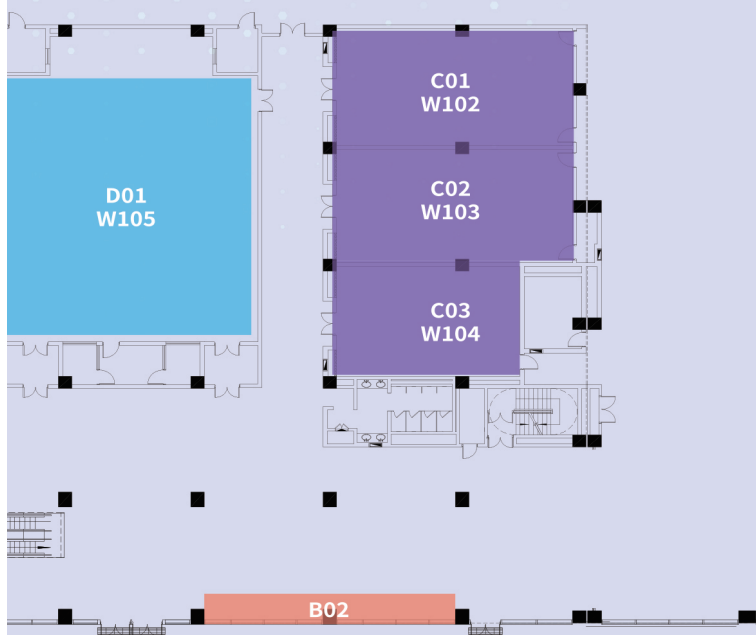

B 媒体公共办公区 Press Workroom (Open Seating)

- 01 媒体办公区
Media Work Area
- 02 媒体办公区
Media Work Area
- 03 茶歇办公区
Tea Break & Work Area

C 媒体专用工作区 Reserved Media Room

- C01 W102 媒体中心工作间
Media Center Workroom
- C02 W103 中央广播电视总台媒体工作间
China Media Group (CMG) Workroom
- C03 W104 嘉宾采访间
Guest Interview Room
- C04 W4-203 新华网媒体工作间
XINHUANET Workroom
- C05 W3-203 中央广播电视总台新闻新媒体
CMG Digital News Center Workroom

二楼区域 Second Floor

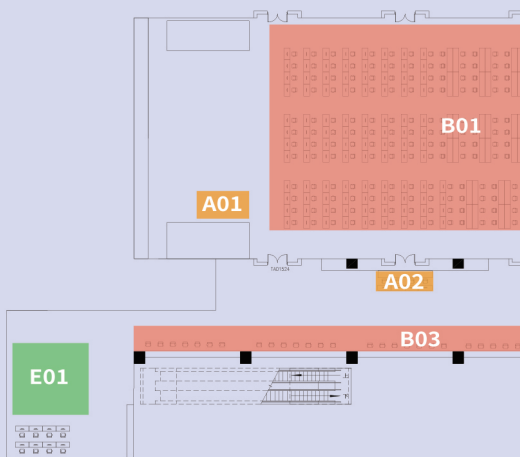

ms

om

体中心媒体工作间
om

- | | |
|--|--------------------------------------|
| C06 W3-202 中央广播电视总台新闻中心媒体工作间
China Media Group(CMG) News Center Workroom | C11 W1-203 新华社媒
Xinhua News Ag |
| C07 W3-201 北京实顺文化传媒有限公司媒体工作间
Beijing Shisoone Culture Media Co., Ltd. Workroom | C12 E4-203 央视视频媒
China Media Gro |
| C08 W2-203 CGTN (中国国际电视台) 媒体工作间
China Global Television Network (CGTN) Workroom | C13 E4-202 环球时报
Huanqiu.com W |
| C09 W2-202 央视网媒体工作间
CCTV.com Workroom | C14 E4-201 北京广播
Beijing Radio & T |
| C10 W2-201 中央广播电视总台财经节目中心媒体工作间
CMG Business Programming Center Workroom | C15 E3-202 凤凰卫视
Phoenix TV Worl |

oor Area



媒体工作间
Media Workroom

网络工作间
Network Mobile Workroom

在线(北京)文化传播有限公司媒体工作间
Online (Beijing) Culture Communication Co., Ltd. Media Workroom

电视台媒体工作间
Television Station Workroom

媒体工作间
Media Workroom

C16 E3-201 《人民画报》媒体工作间
China Pictorial Workroom

C17 E2-203 中国网媒体工作间
China.org.cn Workroom

C18 E2-201 中国贸促会融媒体中心(中国贸易报社有限公司)媒体工作间
CCPIT Media Center (China Trade News) Workroom

C19 E1-203 中国贸促会融媒体中心(中国贸易报社有限公司)媒体工作间
CCPIT Media Center (China Trade News) Workroom

C20 W202 《人民日报》媒体工作间
People's Daily Workroom

二楼专用工作区 Work

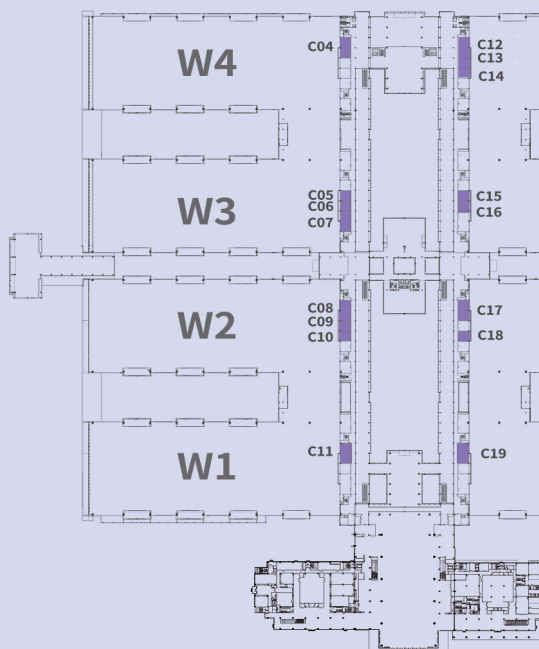

D 新闻发布区 Press Conference Area

D01 W105 新闻发布厅
Press Conference Hall

E 餐饮与茶歇区 Catering and Tea

- E01 茶歇区
Tea Break Area
- E02 自助取餐区
Self-Service Food Pickup Area
- E03 自助取餐区
Self-Service Food Pickup Area
- E04 就餐区
Catering Area

间
作间

ing Area

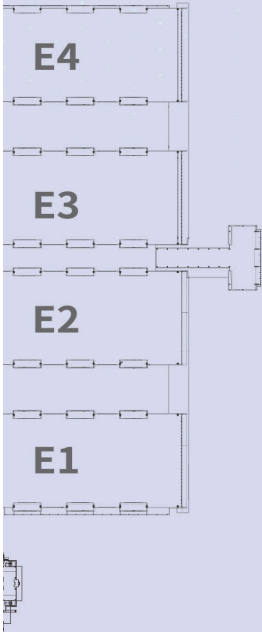

Break Area

F 贵宾区
VIP Area

F01 贵宾室1
VIP1

F02 贵宾室2
VIP2

ea

ea

7. Transportation Services

Shuttle Bus Services

During the Fourth CISCE, media shuttle buses are available free of charge by presenting their media credentials in order to facilitate the interview activities of registered journalists.

Shuttle bus schedules for the Fourth China International Supply Chain Expo will be adjusted in real time. Please refer to the on-site arrangements during the exhibition period. For shuttle bus routes to and from other destinations, please refer to the shuttle service information displayed on the screens in the Media Center .

Shuttle Bus Route

Route	Departure Point & Terminus	Service Period	Departure Time	Size	Number of Buses per Trip
Route 1	Parking lot next to Hall 7 at China International Exhibition Center (Chaoyang Venue) ↓ China International Exhibition Center (Shunyi Venue) North side (35 mins driving time) 20km	June 15th June 21th	From Chaoyang Venue: 7:30 From Shunyi Venue:19:00,22:00	bus or minibus	Arrange vehicles according to the requirements
		June 22th	From Chaoyang Venue:12:00 (To be confirmed) From Shunyi Venue:18:30,22:00		
		June 23th June 26th	From Chaoyang Venue:7:30 From Shunyi Venue:18:30,22:00		
		Transportation support contact person: Zhanrui Kang 13910281733 and Yuqiu Tao15910634514			





Transportation Guide

(1) Public Transportation:

- Subway: Take Line 15 and alight at Guozhan station. Line 15 offers transfers to Line 5, Line 8, Line 13, and Line 14.
- Bus: You can take Bus 915 (heading to Shunyi), Bus 916 (heading to Huairou), Bus 918 (heading to Pinggu), Bus 970 (heading to Miyun), or Bus 850, and disembark at Maliandian station.

(2) Self-Driving:

- From the Airport Expressway: Take the Yanglin Exit, then proceed on Yanglin Avenue and Tianbei Road to reach the Venue.
 - From Jingmi Road: Turn left at the Maliandian intersection onto Tianbei Road, which will lead you to the Venue.
 - From Jingcheng Expressway: Take the Huosha Road (Houshayu) Exit, then follow Huosha Road to the Luoma Roundabout. From there, continue on Tianbei Road to reach the Venue.
- 
- 

8. Hotel Services

At present, 17 recommended hotels have been released, 12 of which are located around the CIEC Shunyi Venue (near the Beijing Capital Airport), while 5 are in downtown Beijing.

The following hotels are recommended as accommodation options for official media (at your own expense). Registered journalists are advised to make early reservations upon receiving the confirmation letter.

The Recommended Hotel Receptionist (From T&A Team)				
No	Hotel Name	Preferential Rate	Room Type	Distance to New CIEC
1	Crowne Plaza Beijing International Airport ♥♥♥♥♥ No.60 Fujan 1st Street, Shunyi District, Beijing, 101312, China	¥950/N incl. breakfast	Superior Room	0.5km 10 minutes on foot
		¥1050/N incl. breakfast	Deluxe Room	
2	Hilton, Beijing Capital Airport ♥♥♥♥♥ Terminal 3, Beijing Capital International Airport, Shunyi District, 100621 Beijing, China	¥800/N incl. breakfast	Deluxe Room	8km 18 minutes by car
3	Cordis, Beijing Capital Airport ♥♥♥♥♥ No. 1 Yijing Road, Terminal 3, Beijing Capital International Airport, Shunyi District, 100621 Beijing, China	¥780/N incl. breakfast	Superior Room	8km 18 minutes by car
4	Crystal Orange Beijing Capital International Convention and Exhibition Center ♥♥♥♥♥ Building 2, No. 45 Courtyard, Yu'an Road, Shunyi District, Beijing	¥760/N incl. breakfast	Business Room	3.2km 8 minutes by car

5	Holiday Inn Beijing Airport Zone  No.35 Nanchen Road, Shunyi District, Beijing, 101300, China	¥480/N incl. breakfast	Standard Room	12km 25 minutes by car 3 stations by 15 Line subway
6	Madison Hotel Beijing Capital Airport New China International Exhibition Center  Building 1, No. 10 Yard, Tianwei 4th Street, Shunyi District, Beijing	¥500/N incl. breakfast	Standard Room	1.1km 8 minutes by car
7	Beijing LanWan International Hotel (Capital Airport New China International Exhibition Center Branch)  No. 22 Tianzhu East Road, Tianzhu Town, Shunyi District, Beijing	¥470/N incl. breakfast	Standard Room	2.6km 10 minutes by car
8	Ibis Styles Hotel (Beijing Capital Airport)  No. 32 Fuqian 1st Street, Shunyi District, Beijing, 101312, China	¥490/N incl. breakfast	Superior Room	3.2km 10 minutes by car
9	VOYAGE INTERNATIONAL HOTEL (Capital Airport New China International Exhibition Center Store)  No. 1, Fuqian 2nd Street, Tianzhu Area, Shunyi District, Beijing	¥530/N incl. breakfast	Standard Twin Room	3km 10 minutes by car
		¥500/N incl. breakfast	Standard King Room	
10	Vienna Classic Hotel(BeiJing New China International Exhibition Center Capital Airport store)  No. 17, Tianzhu Home, Xiaotianzhu 1st Street, Tianzhu Town, Shunyi District, Beijing, China	¥520/N incl. breakfast	Superior Room	6.1km 15 minutes by car
11	Hampton by Hilton Beijing Capital Airport CIECC  No. 4, Building 1, No. 35 Yard, Shuangyu North Street, Shunyi District, Beijing	¥600/N incl. breakfast	Superior King Room	2.6km 10 minutes by car
		¥628/N incl. breakfast	Superior Twin Room	



12	PALACE HOTELS(Beijing Capital Airport New China International Exhibition Center) ◆◆◆◆◆ Building 2, No. 1 Courtyard, Shuangyu South Small Street, Shunyi District, Beijing	¥500/N incl. breakfast	Superior Room	7.2km 18 minutes by car
Hotels in downtown				
13	Kerry Hotel, Beijing ★★★★★ No.1 Guanghua Road, Chaoyang District, Beijing, 100020, China	¥1350/N incl.1 breakfast	Deluxe King Room	14 stations by subway 50 minutes by car
		¥1450/N incl.1 breakfast	Deluxe Twin Room	
14	Kempinski Hotel Beijing Yansha Center ★★★★★ No.50 Liangmaqiao Road, Chaoyang District, Beijing, 100125, China	¥1000/N incl.1 breakfast	Superior Room	10 stations by subway 35 minutes by car
15	Hilton Beijing ★★★★★ No. 1 Dongfang Road, East 3rd Ring North Road, Chaoyang District, Beijing, 100027, China	¥1100/N incl.1 breakfast	Superior King Room	10 stations by subway 35 minutes by car
		¥1200/N incl.1 breakfast	Superior Twin Room	
16	Kuntai Hotel ◆◆◆◆◆ No.2 Qiyang Road, Chaoyang District, Beijing, 100102, China	¥800/N incl.1 breakfast	Deluxe Room	4 stations by subway 30 minutes by car
17	Landmark Towers Hotel ★★★★★ 8 North Dongsanhuan Road (Dongsanhuan Bei Lu) Chaoyang District, Beijing	¥600/N incl. breakfast	Standard Room	10 stations by subway 40 minutes by car

Contacts:

Yuannong Zhao 18612291380

(Wechat ID same as phone)

Weijing Yang 18612291382

(Wechat ID same as phone)

Xiang Li 18612291379

(Wechat ID same as phone)

Tel No.: +86-10-68372681

Email: times@sdlm.cn

Service supervision: +86 18611709678



Scan the QR code
to book the hotel



中国国际供应链促进博览会

China International Supply Chain Expo (CISCE)

**Guide Maps
of CIEC
(Shunyi Venue)**



中国国际供应链促进博览会

China International Supply Chain Expo (CISCE)

Venue Layout

第四届链博

W4 馆
供应链服务展区
Supply Chain Service

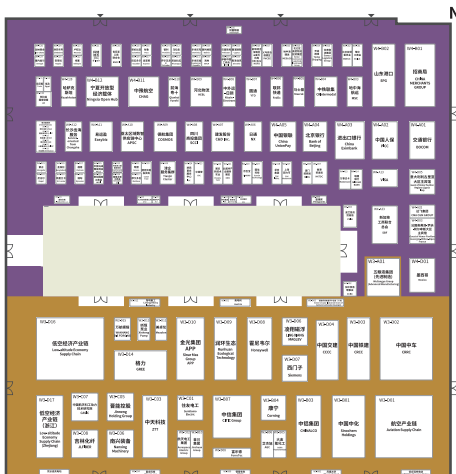

西登展厅
West Entrance

W2 馆
数智科技链
Digital Technology

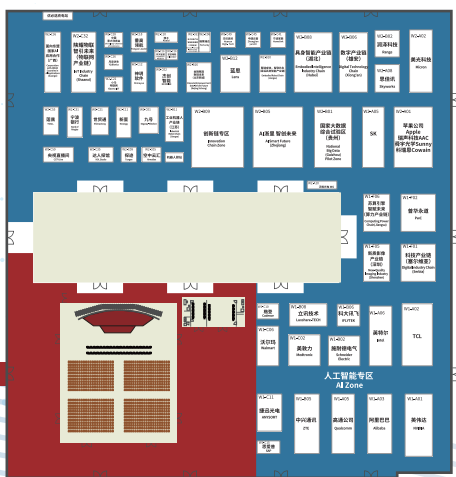

会议中心
Conference Centre



Traffic Map of Shunyi Hall



Anhua Rd





Traffic Map

火沙路出口
Huosha Highway Exit

京承高速公路
Jingcheng Highway

五环路 5th Ring Rd

换乘8号线
Transfer to Line 8

换乘5号线
Transfer to Line 5

换乘13号线
Transfer to Line 13

换乘14号线
Transfer to Line 14

四环路 4th Ring Rd

奥林匹克公园
OLYMPIC PARK

大屯路东
DATUNLU East

望京西
WANGJING West

三环路 3rd Ring Rd

二环路 2nd Ring Rd

15号线 2nd Ring Rd

15号线 3rd Ring Rd

顺义馆 ▶

轨道交通
您可选乘地铁15号线抵达(国展站) 国展顺义馆。

地面公交
您可选乘公交车辆696路、850路、915路、916路、郊81路(马连店公交站或地铁国展站) 抵达国展顺义馆。

Shun

Subwa

Take \$

Internat

Bus Ro

Take B

81, ge

Station



中国国际供应链促进博览会

China International Supply Chain Expo (CISCE)

主办方 Host



中国国际贸易促进委员会
CHINA COUNCIL FOR THE PROMOTION OF INTERNATIONAL TRADE

承办方 Organizer



中国国际展览中心 集团有限公司
CHINA INTERNATIONAL EXHIBITION CENTER GROUP LIMITED

战略合作伙伴 Strategic Partner

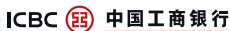

中国工商银行

官方合作伙伴 Official Partners



中国银行
BANK OF CHINA



中国农业银行
AGRICULTURAL BANK OF CHINA



中国人民保险



交通银行
BANK OF COMMUNICATIONS



问界

合作伙伴 Partners



中国国际技术贸易仲裁委员会
CHINA INTERNATIONAL TECHNICAL TRADE ARBITRATION COMMISSION



中国贸促会知识产权事务中心
CCPIT INTELLECTUAL PROPERTY & TRADE LAW OFFICE



中国专利代理(香港)有限公司
CHINA PATENT AGENT (HONG KONG) LIMITED

优必选



AIR CHINA
中国国际航空公司



APP



winner
稳健医疗



Purcotton 全棉时代

媒体合作伙伴 Media Partners



人民日报 数字传播



www.news.cn
新华网
NEWS
www.xinhuanet.com



CGTN



中国网
china.com.cn
china.org.cn



BRTV
北京广播电视台
BEIJING RADIO & TELEVISION STATION



长安街知事
CAPITAL NEWS



中国国际供应链促进博览会

China International Supply Chain Expo (CISCE)

链接世界 · 共创未来

Connecting the World for a Shared Future